

# 1D

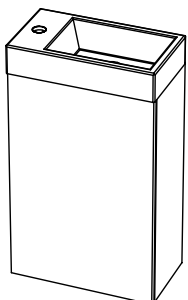
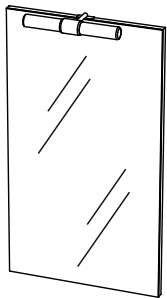
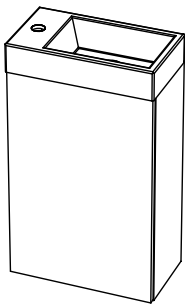
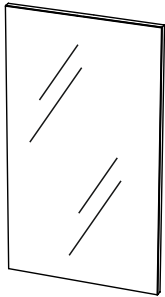
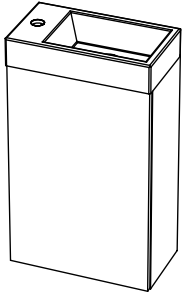

Podczas wiercenia należy stosować odpowiedni sprzęt ochronny (okulary ochronne, ochrona słuchu).

Beim Bohren entsprechende Schutzausrüstung (Schutzbrille, Gehörschutz) tragen.

Wear appropriate protective equipment when drilling (safety goggles, ear protection).

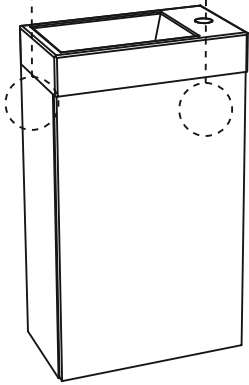
**1a****V1**

64cm +/- 2 cm

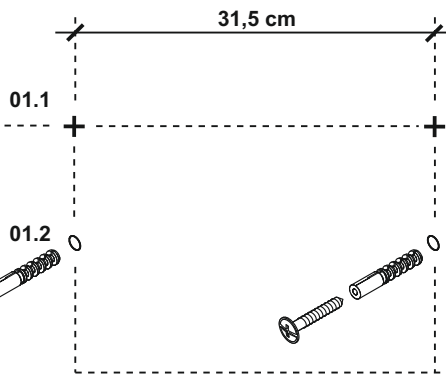

31,5 cm

01.1

01.2

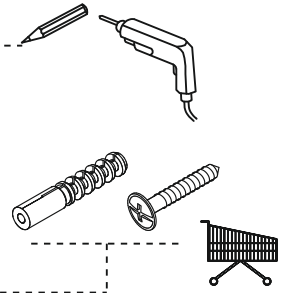

Wybierz / Kup materiał montażowy odpowiedni do rodzaju ściany.

Befestigungsmaterial entsprechend der Wandbeschaffenheit wählen/kaufen.

Choose/Buy mounting material according to the wall texture.

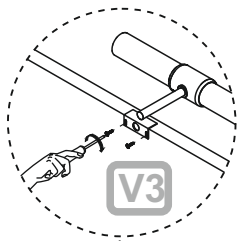
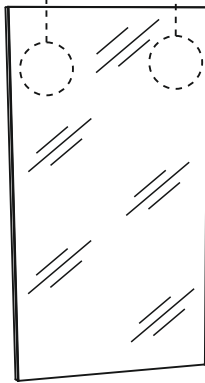
**1b****V2****V3****V3**

155cm +/- 10 cm

22,5 cm

01.1

01.2

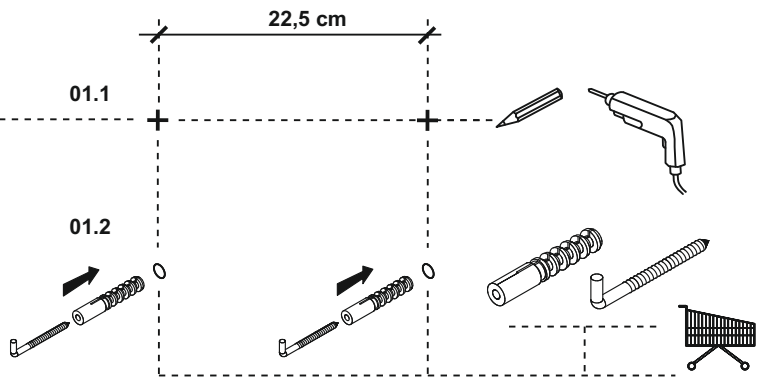

31,5 cm

01.3

01.4

64cm +/- 2 cm

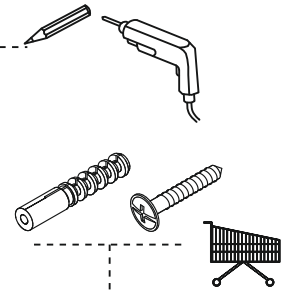
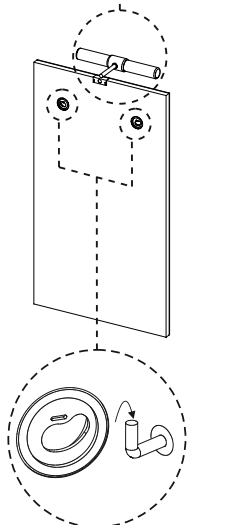
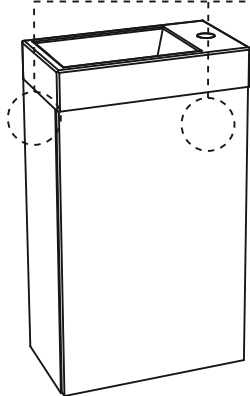

Wybierz / Kup materiał montażowy odpowiedni do rodzaju ściany.

Befestigungsmaterial entsprechend der Wandbeschaffenheit wählen/kaufen.

Choose/Buy mounting material according to the wall texture.



1c

V1 V2 V3

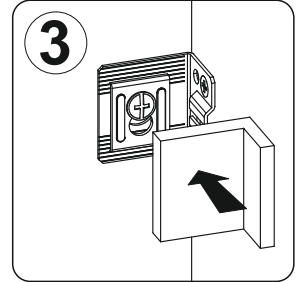
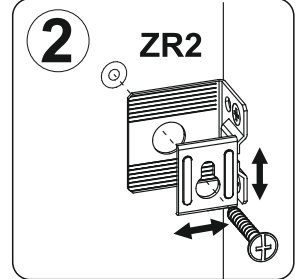
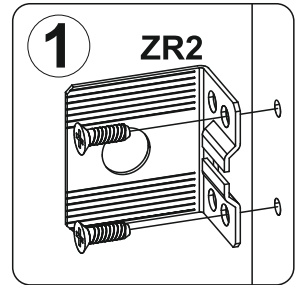
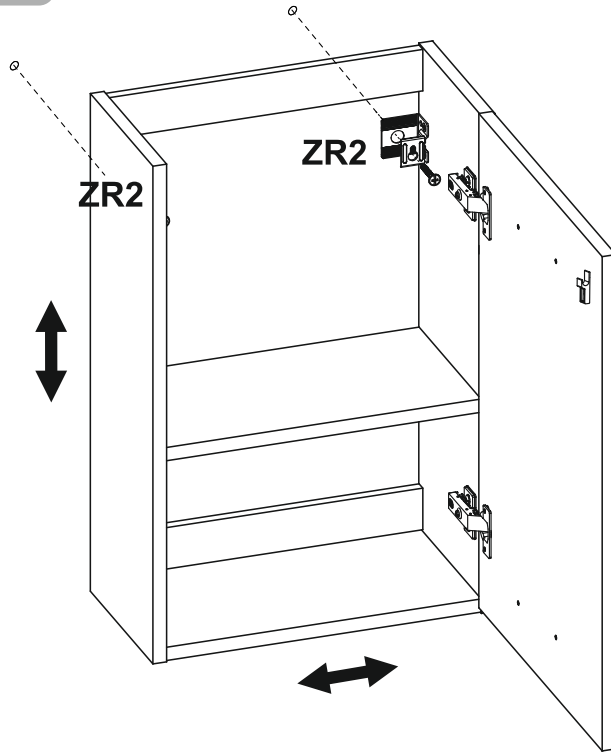
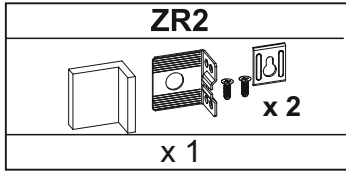

2

V1 V2 V3



03.

04.

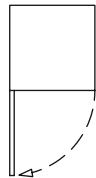

05.

03.

04.

3

V1 V2 V3

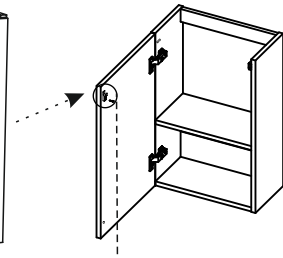
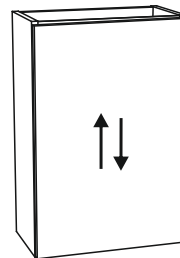
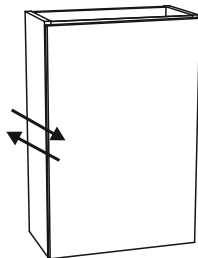
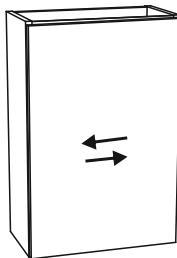

I2

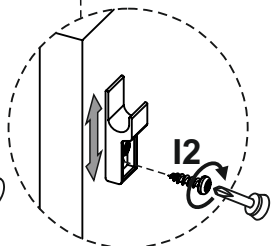
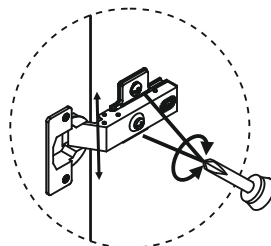
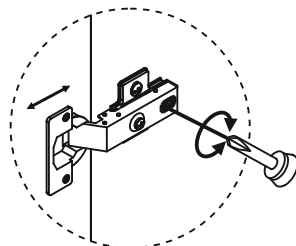
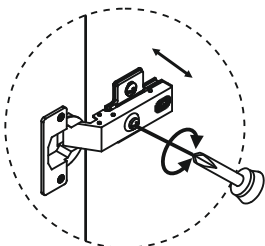
UP3x12
x 1





4

V1

V2

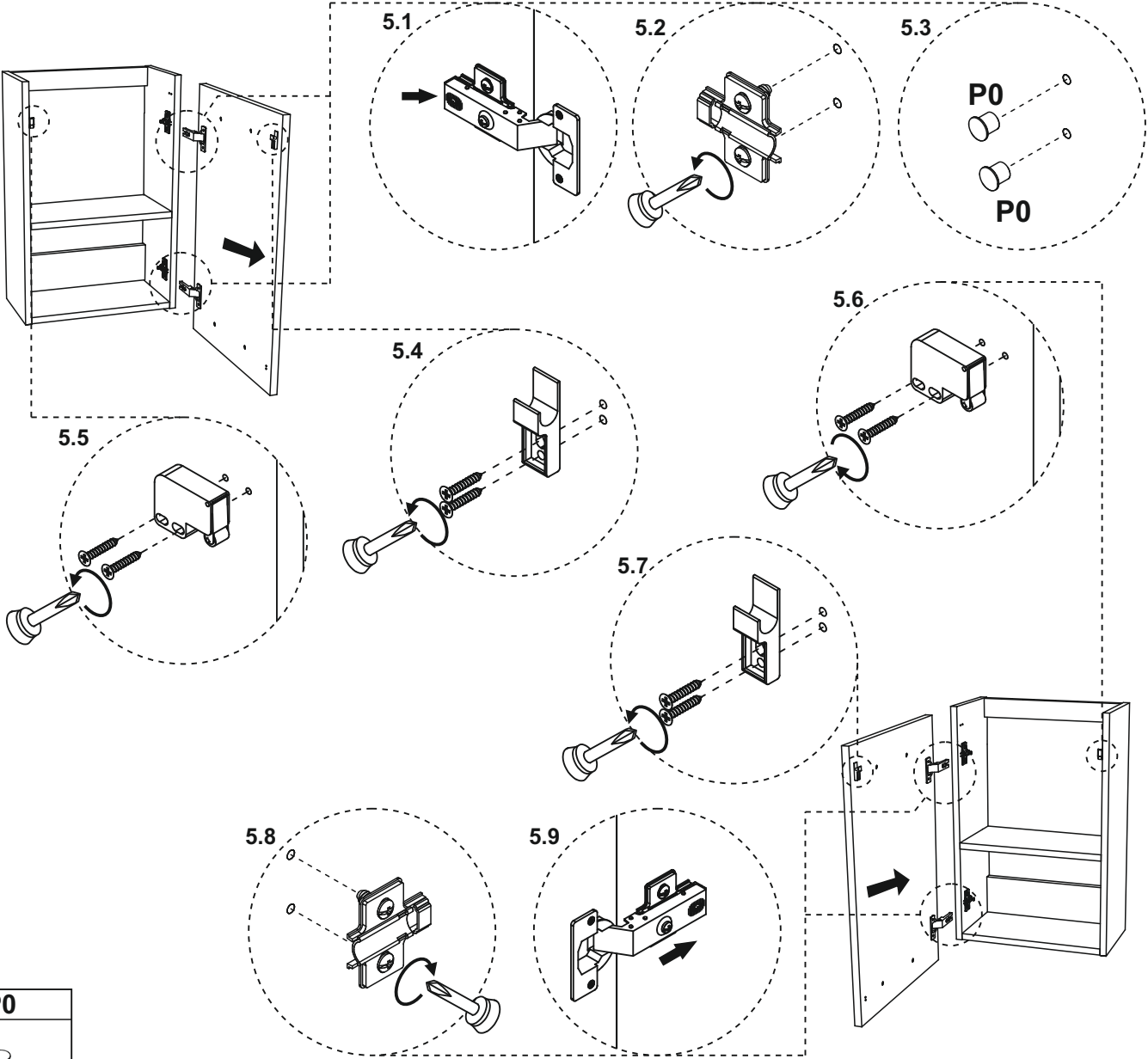
V3



P0

x 8

5

V1

V2

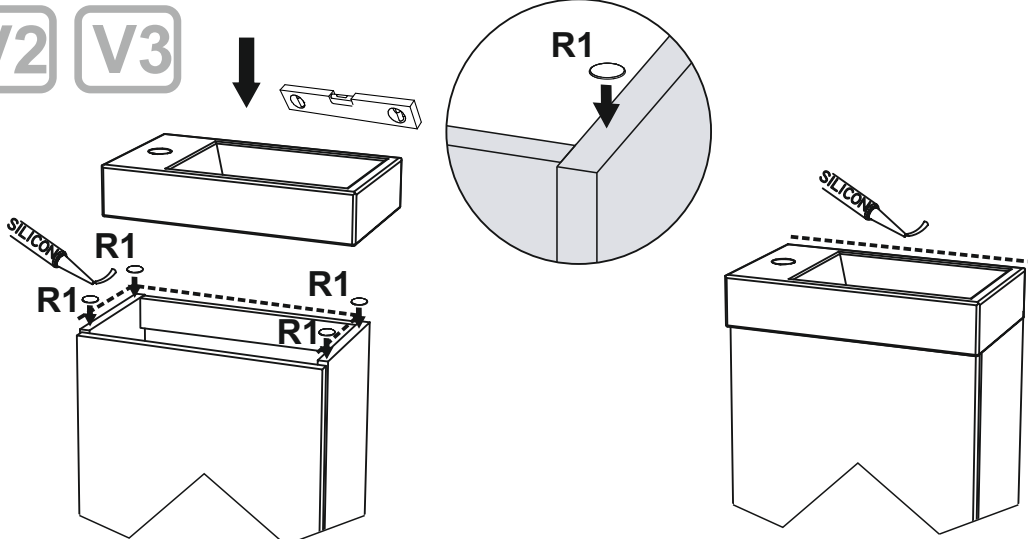
V3



R1

x 4